

The **CONNECT SERIES** Half-Rack is a 1U mountable smart amplifier for use in professional AV integration projects.

It is made to mount directly into a standard AV rack, right out of the box. Additionally, you can rotate the rack ears 90 degrees either direction to mount the amplifier to walls, tables, and other surfaces.

Ensure your AC power source delivers 100-240VAC +/- 15% 50/60Hz before installing.

For full product details and specs, download the manual at the URL below or scan the QR code.

### Downloads



[www.leaprofessional.com/downloads](http://www.leaprofessional.com/downloads)

## In The Box

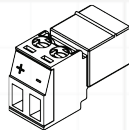

**2-Position Amphenol Anytek Output Connector**  
Qty 1 (per output channel)  
LEA Part #: CPP10008-1

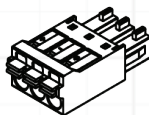

**3-Position Amphenol Anytek Input Connector**  
Qty 1 (per output channel)  
LEA Part #: CSP10006-1



**Standard IEC Power Cord**  
Qty 1  
LEA Part #: MOS10013-1

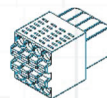

**8-Pin I/O Input Connector**  
Qty 1  
LEA Part #: CSP10004-1

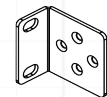

**Detachable Rack Ears**  
Qty 2  
LEA Part #: MFM1002-1



**1/2 Rack Blank Plate**  
Qty 1  
LEA Part #: MFM10034-1  
Flat Screws [4] MSI10002-1

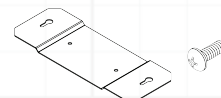

**Wall/Behind TV Mount**  
Qty 1  
LEA Part #: MFM10035-1  
Pan Screws [2] MSI10009-1

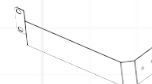

**19" Rack Mount Hardware**  
Qty 1  
LEA Part #: MFM10033-1



**Feet**  
Qty 4  
LEA Part #: MOS10029-1  
Pan Screws [4] MSI10011-1

## Front Panel Overview

### Shark Fin LED



**Green Fin**  
AC plugged in  
Unit powered off  
Via Remote On/Off  
GPIO pin



**Blue Fin**  
AC plugged in  
Unit powered on

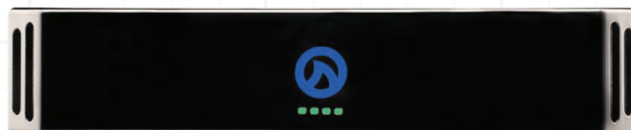

### Channel Status Indicators

**Channel Fault** - If LEDs are pulsing red (1 second on, 1 second off) channel has shut down due to protected circuits.

**Channel Thermal** - If LEDs are alternating between amber and red channel is at or close to over temp.

**Channel Clip** - A red LED indicates a clipping signal, an amber LED indicates channel is limiting.

**Signal Presence** - A green LED indicates -40dB of signal is present on that channel.

**Channel Ready** - A white LED indicates channel is ready to pass audio.

For more information and instructions on various mounting options, scan the adjacent QR code.

### Mounting Options



For more information on amplifier indicator states or troubleshooting, scan the adjacent QR Code or email our technical support team:

[techsupport@leaprofessional.com](mailto:techsupport@leaprofessional.com)

### Training Videos



## Back Panel Overview

For model-specific views and back panel explanations, scan the QR code below to view and download the user's manual.

#### 1. IEC Type Inlet

For detachable IEC connector  
100VAC-240VAC 50/60Hz

#### 2. Power Button

ON/OFF switch  
O=OFF I=ON

#### 3. GPIO Port

With remote ON/OFF  
& Fault Status

#### 4. Channel Outputs

2-position output receptacles  
for up to 4 channels

#### 5. RCA Unbalanced Inputs

RCA inputs are in parallel with  
the Analog Balanced inputs

#### 6. Analog Balanced Inputs

3-position input receptacles  
switchable between mic and  
line level input

#### 7. Wi-Fi Access Point

Enable/Disable button  
with status LED  
AP=Blue Wi-fi=Green

#### 8. FAST 10/100MB Ethernet

Cat5 or Cat6 input for  
control, monitoring and POE

#### 9. Dante Input

Single Dante input for 48kHz  
Dante Networks

#### 10. LCD Display

Networking information

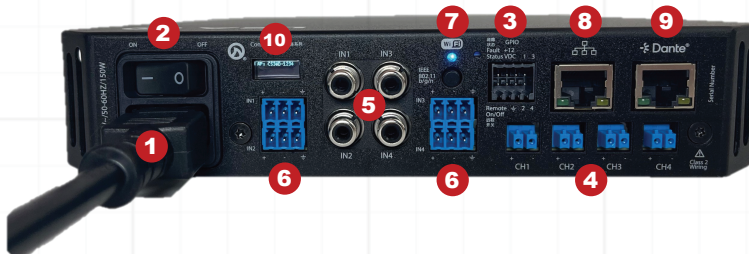

### Manual



## GPIO Port

### Fault Status

Analog connection for quick amp fault status. Delivers 5V signal.

5V ON = no faults  
5V OFF = fault present

### Remote ON/OFF

This is wired directly to a switch or external contact closure for quick ON/OFF control of the amplifier.

OPEN = amp on  
CLOSED = amp off

Fault +12  
Status VDC 1 3

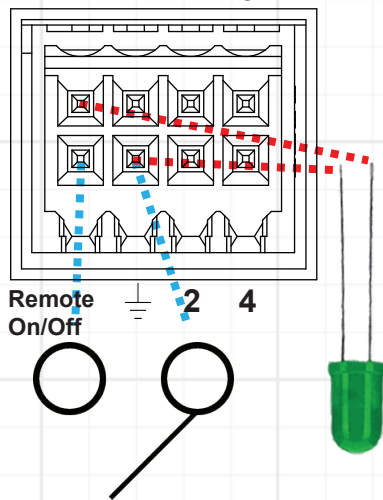

## Smart Power Bridge

Smart Power Bridge gives you the benefits of a bridged output channel without sacrificing an amp channel.

You can Smart Power Bridge any one channel of an LEA Connect Series amplifier. For example, on a Connect Series 4 channel product, you can put channel 1 in Smart Power Bridge mode and get double the power output on that channel, channel 2 in 70V or 100V mode and have channel 3 and 4 in Low-Z mode.

## Connecting to the Network

There are three ways to choose from when connecting to a network. Scan the QR code for a detailed video walkthrough.

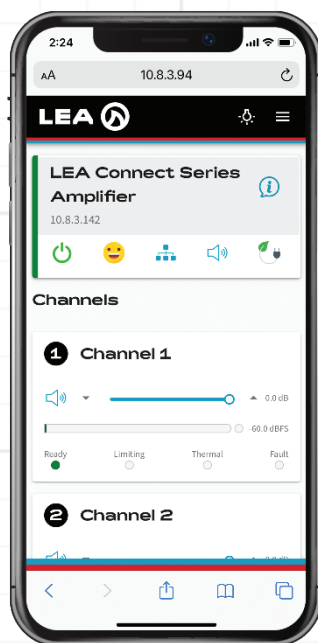

### Access Point Mode

1. Press Wi-Fi Button on back of amp
2. The amp creates its own Access Point (LED above button turns blue) - find and connect to it on your device (Phone, tablet, PC)
3. Enter the amp's IP address into any web browser on your device (Phone, tablet, PC)

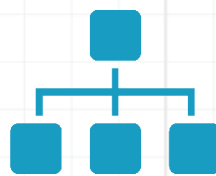

### Wired Mode (Ethernet)

1. Connect to the wired network using Cat5 or Cat6
2. Connect your device (Phone, tablet, PC) to the same network
3. Enter the amp's IP address into any web browser on your device (Phone, tablet, PC)



### Wi-Fi Mode

1. Follow the steps in the AP or Wired instruction to the left
2. In "Network Settings", check the "Wi-Fi Enabled" box
3. Enter your Wi-Fi SSID & Password & click "Save"
4. From Wired mode, no action needed. From AP mode, press Wi-Fi button on back of amp
5. Connect your device to the same network, enter the amp's IP address in the web browser

### Networking Training Video



## Connecting to the Cloud

1. For remote control, visit: [www.leaprofessional.cloud](http://www.leaprofessional.cloud)
2. Select "Register New Account" to create a Username & Password
3. Follow the prompts to log in to your Cloud Account
4. For more details, scan the QR code



## Accessories



**RCAF-2**  
Female RCA to Amphenol Anytek  
3-pin Connector  
Qty 2 per order



**XLRF**  
Female XLR to Amphenol Anytek  
3-pin Connector  
Qty 1 per order

### Accessories Spec



## Get More

For more information, training videos, product spec, downloads, and contact details, visit our website or scan the QR codes to the right.

[www.leaprofessional.com](http://www.leaprofessional.com)

### Manual



### Latest Firmware



### Training Videos



### Product Registration



### Website

